

INDIVIDUAL PARTS		COMPOSITE PARTS
36194	Flow control spindle	Washer & Gasket KIT-B
99090760	Spindle assembly	29837 Cold washer retainer
99044392	Plaster shield	99631090 Hot washer screw
9962017	Lever handle	27995 Hot and cold washers
29843	Cap	99070002 Handle screw
29844	Renewable Seat Kit	99080365 Packing
29842	Packing nut with o-rings	99712293 Cap gasket
29837	Cold washer retainer	Repair units
99631090	Hot washer screw	29844 Renewable seat unit complete
27795	Hot and cold washers	10322 Renewable seat socket wrench
28216	Escutcheon	36194 Spindle
99510285	Escutcheon screw	
29841	Dome cover and lock nut	
99070002	Handle screw	
99080365	Packing	
99712293	Cap gasket	
**	Top seat o-ring & bottom seat gasket	
99070007	Limit stop with o-ring	
99492657	Plaster shield	
99830761	Dome cover gasket	
99526301	Escutcheon Gasket	
99620016	Escutcheon screw	
99650470	On/Off Indicator	

Comes in Renewable Seat Kit, Item **29844

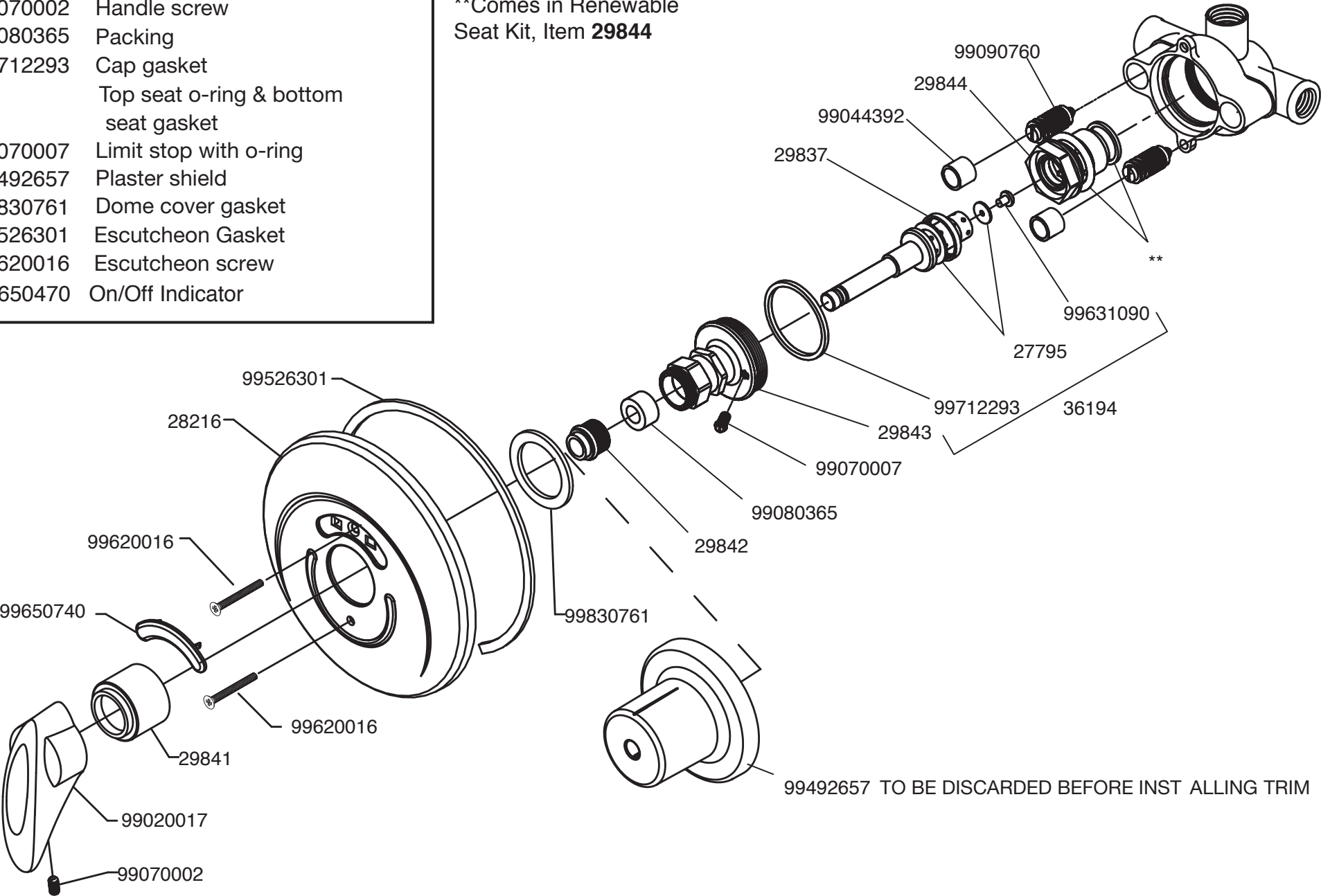

FIBERGLASS WALL INSTALLATION

When installing Safetymix in fiber-glass or panel walls and it is desired to sandwich wall between valve body and escutcheon, cut hole in wall as shown in Figure 4 and mount valve from rear. Note: It is always recommended to secure valve piping to rough construction and not depend on fiberglass wall for valve mounting security. On panel walls over 1” thick, install in conventional manner.

OPERATION OF VALVE

The main handle of the Safetymix valve is for control of temperature only. From the OFF position, the handle is turned counter-clockwise through a minimum cold position, through a warm and hot position for a maximum turn of approximately one revolution. This allows for infinite temperature adjustments to suit the requirements of any user.

CARE AND CLEANING

The lustrous finish on your Safetymix valve should be treated with care. It can be readily damaged by improper handling or abusive treatment. To clean the finish wipe gently with a soft damp cloth and blot dry with a soft towel. Use only a mild soap solution if required. **DO NOT USE ABRASIVE CLEANERS. USE OF POLISH, ABRASIVE CLEANERS, SOLVENTS OR ACID CLEANERS WILL DAMAGE THE FINISH AND VOID THE SYMMONS WARRANTY.**



BEST PLUMBING SPECIALTIES